

AccuLock™ S Consumables

Issued January 2021 • Index No. ALS/2.0

**MIG (GMAW) Welding
Consumables**



Quick Specs

Applications

Shipbuilding
Fabrication
Heavy Equipment
Manufacturing

System Components

Liners
Contact Tips
Nozzles
Diffusers
Power Pins
Power Pin Caps

Compatible With

BTB Series MIG Guns
Miller® MDX™-250 Series MIG Guns

Wire Sizes

0.023" to 3/32"
(0.6 to 2.4 mm)

Load and Lock for Better Productivity

Choosing equipment with fewer points of failure and simplified maintenance can reduce welder training and shorten your troubleshooting list.

AccuLock S Consumables are designed to address liner trim length errors and erratic wire-feeding. Both are common contributors to troubleshooting, rework and production downtime.

Error-Proof Liner Replacement – With AccuLock S Consumables, the liner replacement process has been error-proofed – no more measuring means no more liners trimmed incorrectly!
See page 4 for details.

Optimized Wire-Feeding – AccuLock S Liners are locked and concentrically aligned to both the contact tip and power pin without the use of fasteners to guarantee smooth, uninterrupted delivery of the wire to the weld puddle. This means you'll benefit from **reduced troubleshooting and downtime caused by burnbacks, birdnests, and erratic arc and 2-3x longer contact tip life.**



AccuLock™



Keeps the liner perfectly aligned from the power pin to the contact tip



Eliminates measuring the liner - simply cut flush with the back of the power pin



Contact tips can be used on both semi-automatic and robotic MIG guns



Bernard

A Division of Miller Electric Mfg. LLC
449 West Corning Road
Beecher, Illinois 60401 USA

Phone: 1-855-MIGWELD (644-9353) (US & Canada Only)
+1-519-737-3000 (International)

Fax: 708-946-6726

For more information, visit us at Tregaskiss.com

AccuLock™ S Key Features

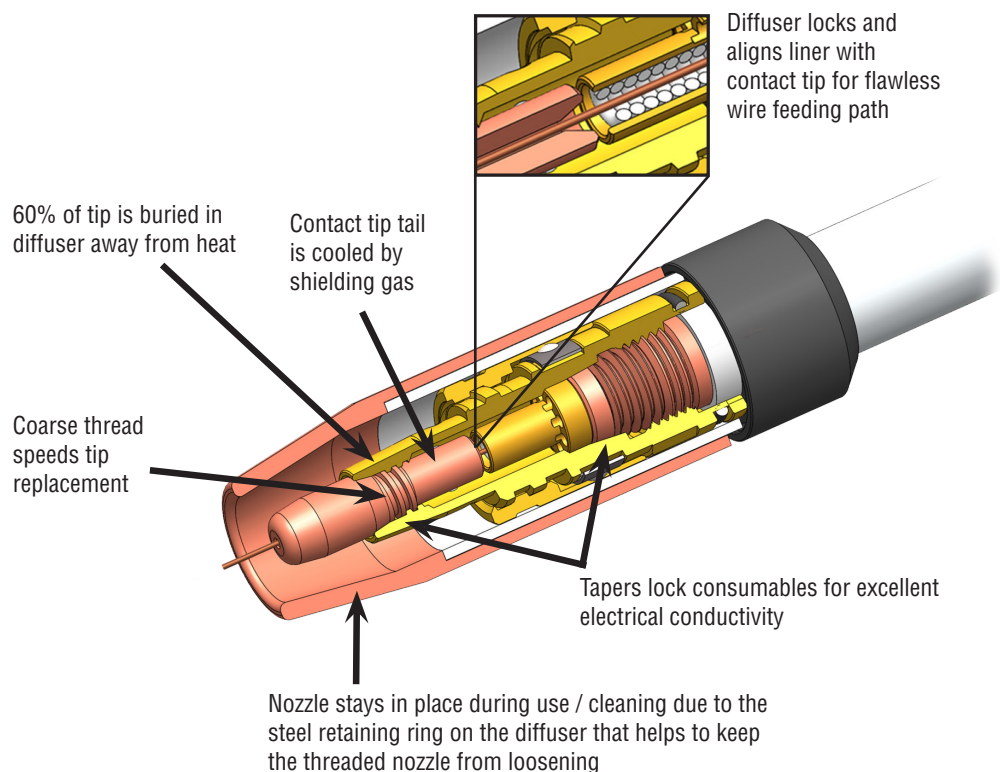

AccuLock S Consumables

Small AccuLock S Diffusers and Nozzles

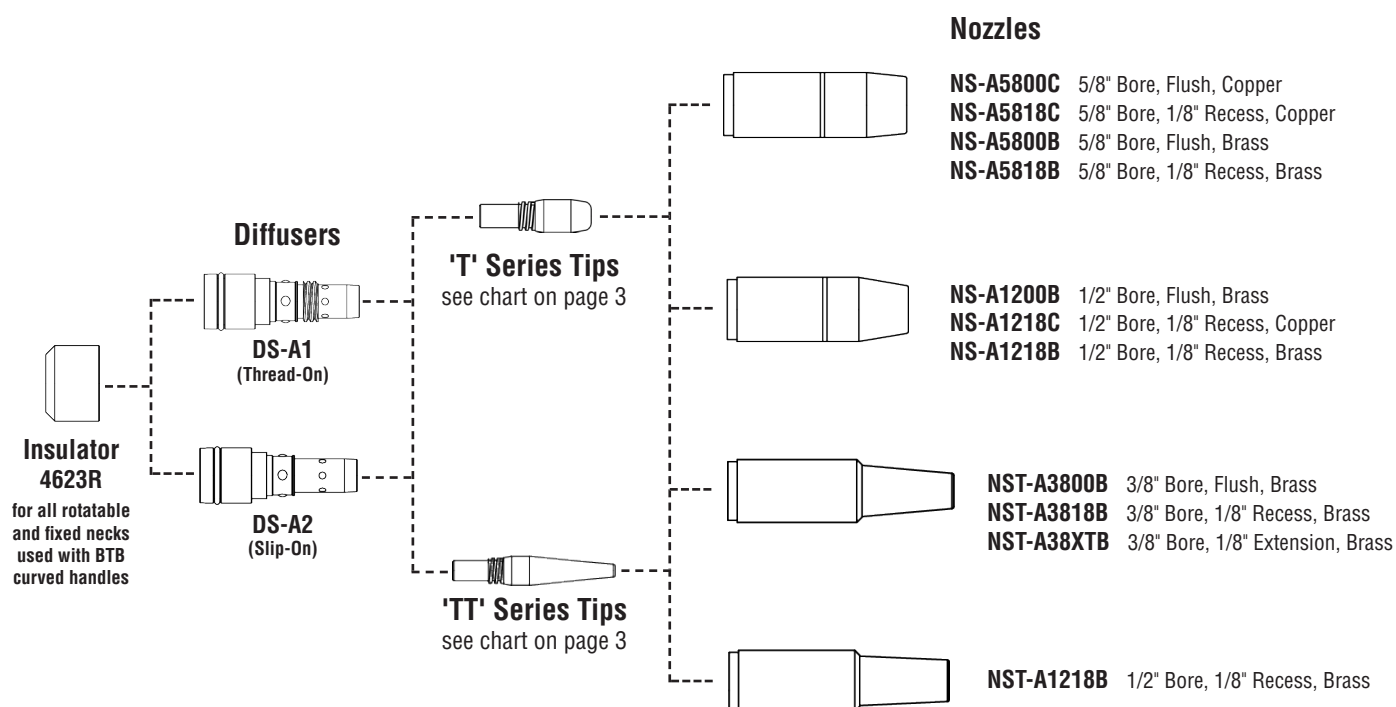

Large AccuLock S Diffusers and Nozzles

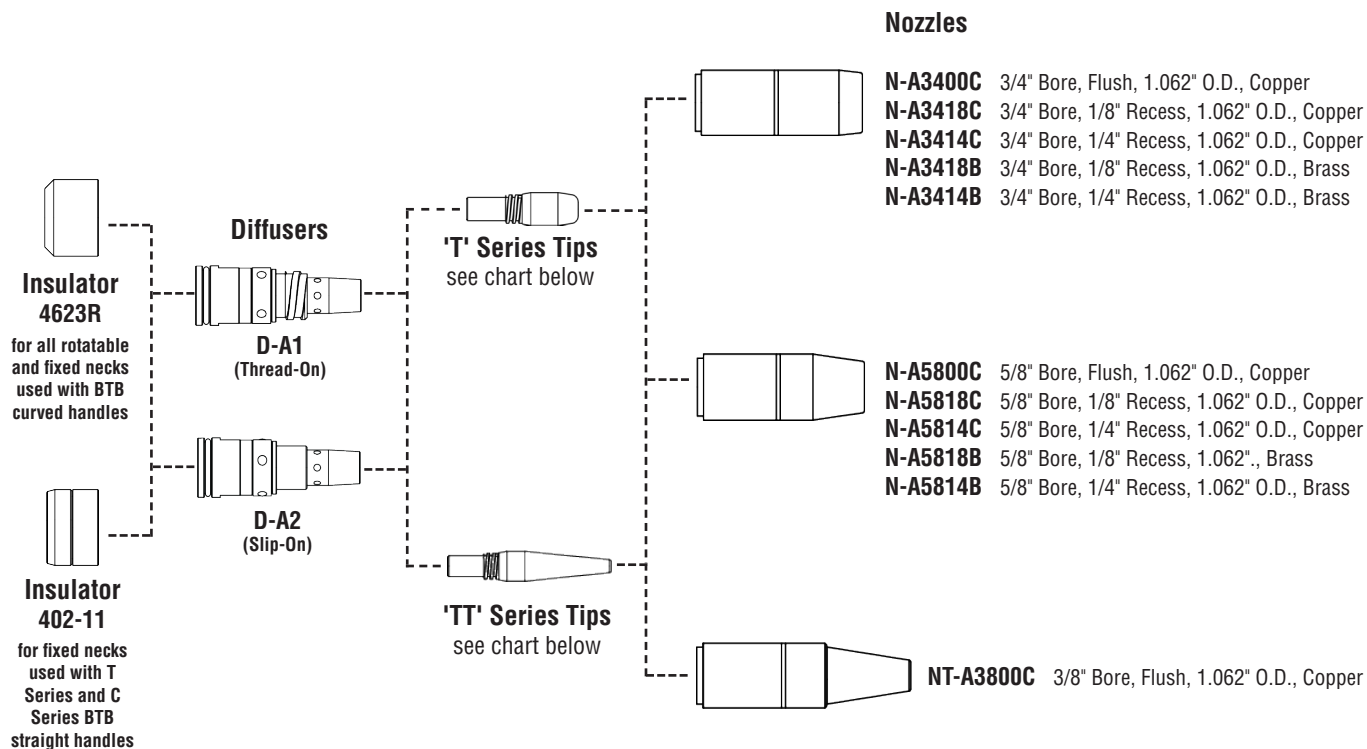

Diffusers and nozzles available in packages of 10
 Insulators are available in packages of 5

AccuLock Contact Tips

'T' Series Contact Tips (0.350" O.D.)

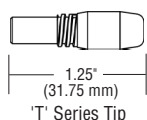

| | | |
|------------------|--------|----------|
| T-A023CH | 0.023" | (0.6 mm) |
| T-A030CH* | 0.030" | (0.8 mm) |
| T-A035CH* | 0.035" | (0.9 mm) |
| T-A039CH* | 0.039" | (1.0 mm) |
| T-A045CH* | 0.045" | (1.2 mm) |
| T-A052CH* | 0.052" | (1.4 mm) |
| T-A062CH | 1/16" | (1.6 mm) |
| T-A072CH | 0.072" | (1.8 mm) |
| T-A078CH | 5/64" | (2.0 mm) |
| T-A094CH | 3/32" | (2.4 mm) |
| T-A109CH | 7/64" | (2.8 mm) |
| T-A125CH | 1/8" | (3.2 mm) |

* Add "-1000" to end of part number listed for packages of 1000

- Torque to 30 in.-lbs. (3.5 Nm)
- Contact Tips Available in packages of 10

'TT' Series Contact Tips (0.350" O.D.)

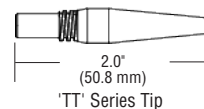

| | | |
|------------------|--------|----------|
| TT-A023CH | 0.023" | (0.6 mm) |
| TT-A030CH | 0.030" | (0.8 mm) |
| TT-A035CH | 0.035" | (0.9 mm) |
| TT-A039CH | 0.039" | (1.0 mm) |
| TT-A045CH | 0.045" | (1.2 mm) |
| TT-A052CH | 0.052" | (1.4 mm) |
| TT-A062CH | 1/16" | (1.6 mm) |

Bernard® AccuLock S and Tregaskiss® AccuLock R Consumables share a common contact tip. If you have a combination of robotic and semi-automatic guns in your facility, you'll benefit from the reduced costs and simplified inventory of a **Common Consumable Platform™**.



AccuLock S Liners

| Wire Size | Liner Color | Cable Length | | | |
|-----------------------------------|---------------|--------------|-------------|-------------|-------------|
| | | 10' (3.05m) | 15' (4.57m) | 20' (6.10m) | 25' (7.62m) |
| 0.023" (0.6 mm) - 0.030" (0.8 mm) | Yellow | LA1A-10 | LA1A-15 | LA1A-20 | LA1A-25 |
| 0.030" (0.8 mm) - 0.035" (0.9 mm) | Green | LA2A-10 | LA2A-15 | LA2A-20 | LA2A-25 |
| 0.035" (0.9 mm) - 0.045" (1.2 mm) | White | LAD3A-10 | LAD3A-15 | LAD3A-20 | LAD3A-25 |
| 0.045" (1.2 mm) - 1/16" (1.6 mm) | Red | LAD4A-10 | LAD4A-15 | LAD4A-20 | LAD4A-25 |
| 5/64" (2.0 mm) - 3/32" (2.4 mm) | Blue | LA6A-10 | LA6A-15 | LA6A-20 | LA6A-25 |

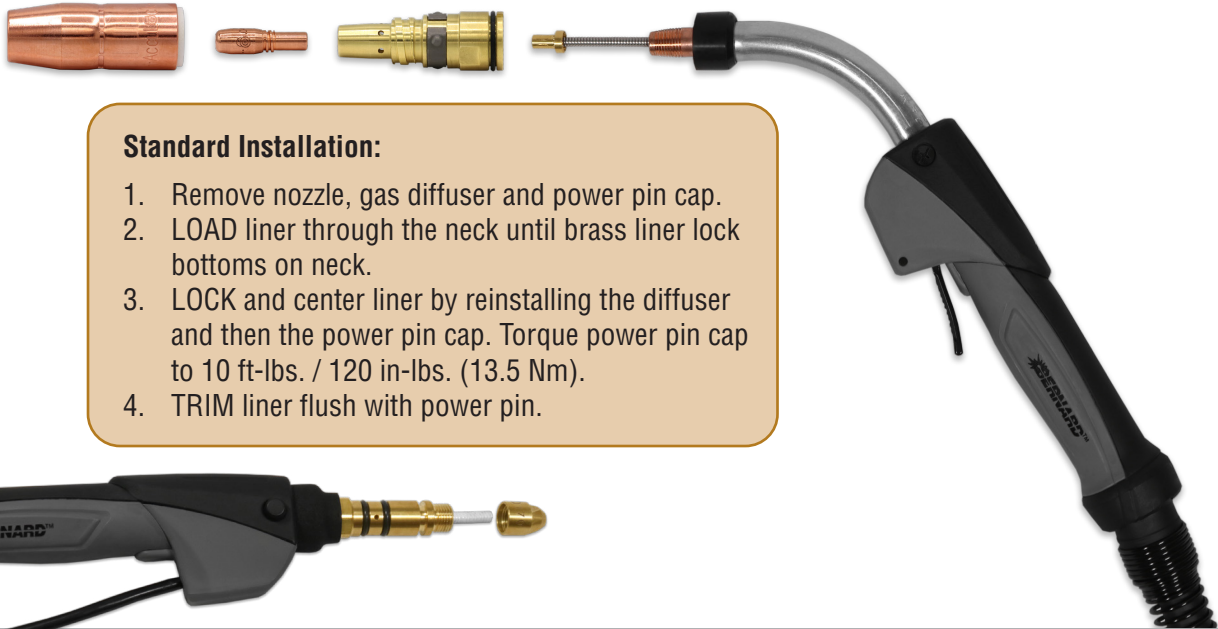

Standard Installation:

1. Remove nozzle, gas diffuser and power pin cap.
2. LOAD liner through the neck until brass liner lock bottoms on neck.
3. LOCK and center liner by reinstalling the diffuser and then the power pin cap. Torque power pin cap to 10 ft-lbs. / 120 in-lbs. (13.5 Nm).
4. TRIM liner flush with power pin.

AccuLock S Power Pin and Power Pin Caps

| | Power Pin | Power Pin Cap | Color of Cap | Compatible Wire Size |
|------------------|-----------|---------------|---------------|-----------------------------------|
| Miller® | 2200206 | 2200170 | Black | 0.023" (0.6 mm) - 0.030" (0.8 mm) |
| | | 2200171 | Blue | 0.030" (0.8 mm) - 0.045" (1.2 mm) |
| | | 2200203 | Orange | 0.045" (1.2 mm) - 3/32" (2.4 mm) |
| Lincoln® | 2200210 | 2200192 | Black | 0.023" (0.6 mm) - 0.030" (0.8 mm) |
| | | 2200193 | Blue | 0.030" (0.8 mm) - 0.045" (1.2 mm) |
| | | 2200212 | Orange | 0.045" (1.2 mm) - 3/32" (2.4 mm) |
| Tweco® #4 | 2200150 | 2200183 | Black | 0.023" (0.6 mm) - 0.030" (0.8 mm) |
| | | 2200184 | Blue | 0.030" (0.8 mm) - 0.045" (1.2 mm) |
| | | 2200209 | Orange | 0.045" (1.2 mm) - 3/32" (2.4 mm) |
| Tweco #5 | 2200156 | 2200186 | Black | 0.023" (0.6 mm) - 0.030" (0.8 mm) |
| | | 2200187 | Blue | 0.030" (0.8 mm) - 0.045" (1.2 mm) |
| | | 2200208 | Orange | 0.045" (1.2 mm) - 3/32" (2.4 mm) |

IMPORTANT NOTE: To convert any Bernard BTB MIG Gun with a Miller, Lincoln, Tweco #4 or Tweco #5 power pin, please follow the above chart to identify the power pin and cap needed for the AccuLock S consumables system.

AccuLock™ contact tips, AccuLock S nozzles, diffusers and liners are manufactured by Bernard. Bernard®, Miller®, Tregaskiss® are trademarks of Illinois Tool Works, Inc. Other brands mentioned are for reference only and are the registered trademarks of their respective companies. Illinois Tool Works, Inc. is not affiliated with these other companies.

Subject to Change – The information presented in this spec sheet is accurate to the best of our knowledge at the time of printing.
Please visit Tregaskiss.com for the most up-to-date information.

Distributed By:

SUPERTECH SERVICES PVT. LTD. Plot :- A253, Road 30B, Wagle Industrial Estate, Tel :- +91 91360 97134 / +91 91360 97135 For more information visit us at : www.supertechservices.in
Thane (West), Maharashtra, India. Email :- ssl@supertechservices.in

