

# Weldcraft™ W-400

## Formerly WP-18SC

**Hand-Held Water-Cooled  
TIG Welding Torches**



### Quick Specs

#### Model

W-400 Super Cool

#### Applications

Aluminum ship repair  
Exotic material fabrication  
Heavy fabrication  
Metal fabrication  
Pipe and tube fabrication

Pressure vessel fabrication  
Tool and die  
Tube mills  
Vocational

#### Rated Output

DC: 400 A, AC: 280 A

**Duty Cycle** 100%

#### Electrode Range

.020–3/16 in. (0.5–4.8 mm)

### W-400 Super Cool™ TIG torch

Formerly known as the WP-18SC, the W-400 Super Cool water-cooled torch is designed to endure some of the most demanding applications while minimizing overheating. The W-400 Super Cool is engineered with cost-effective solutions for high-amperage welding challenges.

**Extend torch and consumable life** with the full-flow water chamber that provides around-the-head cooling.

**Improve gas coverage and cooling capacity** with gas lens usage with heavy-duty stubby collet body.

**Extend parts life** using the durable copper components, maximizing current capacity.

**Comfort and maximum torch control** with the textured handle.

*Note: Torch delivered may vary slightly from image shown.*



**W-400 Super Cool  
(WP-18SC)**



#### Miller Electric Mfg. Co.

An ITW Welding Company  
1635 West Spencer Street  
P.O. Box 1079  
Appleton, WI 54912-1079 USA

#### Equipment Sales US and Canada

Phone: 866-931-9730  
FAX: 800-637-2315  
International Phone: 920-735-4554  
International FAX: 920-735-4125

#### MillerWelds.com



## Torch Packages

Models		Rubber		Vinyl	
Old Model	New Name	12.5 ft. (3.8 m)	25 ft. (7.6 m)	12.5 ft. (3.8 m)	25 ft. (7.6 m)
WP-18SC	W-400 Super Cool™	WP-18SC-12-R	WP-18SC-25-R	WP-18SC-12	WP-18SC-25

*Torch packages include torch body, handle, power cable, long back cap, gas hose, and water hose.*

## Connectors

### Power cable connectors



**195380**  
50 mm Dinse-style gas thru with gas and water return lines for water-cooled torch.



**195377**  
50 mm Dinse-style with water return line for water-cooled torch.



**45V11**  
Power cable adapter for water-cooled torch.



**225028**  
50 mm thread-lock-style for water-cooled torch.

Machines	Connection Type	1-Piece Power Cable Connectors
<b>TIG Machines</b>		
Syncrowave® 200/210	50 mm Dinse-style gas thru	<b>195380</b>
Syncrowave® 250 DX/350 DX (Dinse)	50 mm Dinse-style	<b>195377</b>
Syncrowave® 250 DX/350 DX (stud)	1/2 in. stud	<b>45V11</b>
Dynasty® 200/210/280/350, Maxstar® 200/210/280/350	50 mm Dinse-style	<b>195377</b>
Dynasty® 700, Maxstar® 700	50 mm thread-lock	<b>225028</b>
<b>Multiprocess Machines</b>		
Dimension™ 302/452/NT 450/652	1/2 in. stud	<b>45V11</b>
PipeWorx	1/2 in. stud	<b>45V11</b>
XMT® 304/350	50 mm Dinse-style	<b>195377</b>
XMT® 450	1/2 in. stud	<b>45V11</b>
<b>Engine-Driven Machines</b>		
Most Big Blue®, Trailblazer®, Bobcat™, Blue Star® and Wildcat® models	1/2 in. stud	<b>45V11</b>
Big Blue® 450 Duo CST	50 mm Dinse-style	<b>195377</b>
<b>General Reference</b>		
	50 mm Dinse-style	<b>195377</b>
	50 mm Dinse-style gas thru	<b>195380</b>
	50 mm thread-lock	<b>225028</b>
	1/2 in. stud	<b>45V11</b>
<b>Other Adapter</b>		
	Stud to Dinse-style adapter	<b>232728</b>

## Consumables (Refer to Owner's Manual for additional replacement parts.)

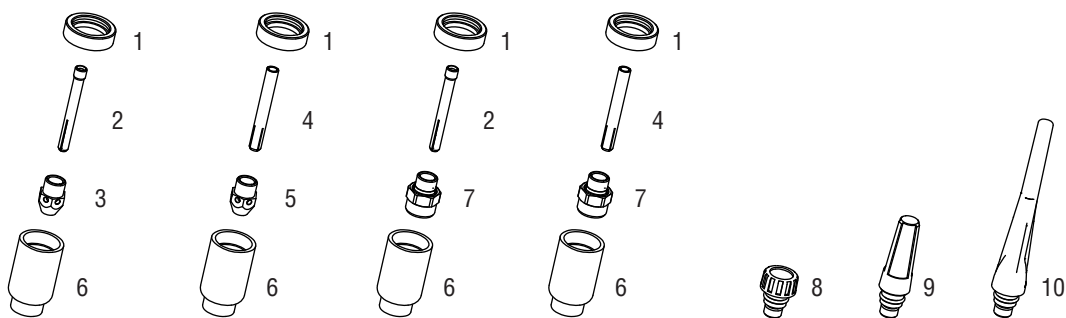

### Non-Gas Lens

Electrode Size — inch (mm)	.020 (0.5)	.040 (1.0)	1/16 (1.6)	3/32 (2.4)	1/8 (3.2)	5/32 (4.0)	3/16 (4.8)	
1 Insulator (required)	18NG	18NG	18NG	18NG	18NG	18NG	18NG	
2 Collet	10N21	10N22	10N23	10N24	10N25	—	—	
3 Collet Body	NCB-53	NCB-53	NCB-53	NCB-53	NCB-53	—	—	
4 Heavy-Duty Collet	—	—	—	—	10N25HD	54N20HD	18C36	
5 HD Nose Collet Body	—	—	—	—	NCB-36	NCB-36	NCB-36	
Nozzle Size — size # (inch)	4 (1/4)	5 (5/16)	6 (3/8)	7 (7/16)	8 (1/2)	10 (5/8)	12 (3/4)	Short
6 Alumina	54N18	54N17	54N16	54N15	54N14	—	—	54N19
* Long Alumina	—	54N17L	54N16L	54N15L	—	—	—	—

### Gas Lens

Electrode Size — inch (mm)	.020 (0.5)	.040 (1.0)	1/16 (1.6)	3/32 (2.4)	1/8 (3.2)	5/32 (4.0)	3/16 (4.8)	
1 Insulator (required)	18NG	18NG	18NG	18NG	18NG	18NG	18NG	
2 Collet	10N21	10N22	10N23	10N24	10N25	—	—	
4 Heavy-Duty Collet	—	—	—	—	10N25HD	54N20HD	18C36	
7 Gas Lens	18GL02	18GL04	18GL16	18GL32	18GL18	18GL53	18GL36	
Nozzle Size — size # (inch)	4 (1/4)	5 (5/16)	6 (3/8)	7 (7/16)	8 (1/2)	10 (5/8)	12 (3/4)	Short
6 Alumina Gas Lens	54N18	54N17	54N16	54N15	54N14	—	—	54N19
* Long Gas Lens	—	54N17L	54N16L	54N15L	—	—	—	—

### Back Caps

8 Short 57Y04      9 Medium 300M      10 Long 57Y02

\*Not shown.

# Tungsten

## Tungsten for the most demanding TIG welding applications!

Available in four types and industry-standard diameters, our line of Weldcraft™ tungsten electrodes has undergone rigorous testing to ensure the highest quality and durability. Color-coded packages include ten 7-inch (175 mm) tungsten electrodes.

*Note: Refer to manufacturer SDS sheets for proper preparation and safety. Use proper ventilation/capture during preparation. Refer to manufacturer warning regarding ventilation.*



Type	Diameter in. (mm)	Part #	Type	Diameter in. (mm)	Part #
<b>2% Ceriated (EWCe-2)</b>			<b>Pure (EWP)</b>		
Performs well in DC welding and arc starting at low-current settings, and offers excellent performance in AC processes.	0.040 (1.0)	WC040X7	Forms a clean, balled end when heated and provides good arc stability for AC welding with a balanced or unbalanced squarewave or sine wave.	0.040 (1.0)	—
	1/16 (1.6)	WC116X7		1/16 (1.6)	WP116X7
	3/32 (2.4)	WC332X7		3/32 (2.4)	WP332X7
	1/8 (3.2)	WC018X7		1/8 (3.2)	WP018X7
	5/32 (4.0)	WC532X7		5/32 (4.0)	—
<b>2% Lanthanated (EWLa-2)</b>			<b>Rare Earth (EWG)</b>		
Provides excellent arc starting, arc stability and re-ignition, and less tip erosion in AC or DC welding. Can substitute for 2% Thoriated.	0.040 (1.0)	WL2040X7	Combines the best of all alloying elements, and provides excellent arc stability in AC or DC welding.	0.040 (1.0)	—
	1/16 (1.6)	WL2116X7		1/16 (1.6)	WG116X7
	3/32 (2.4)	WL2332X7		3/32 (2.4)	WG332X7
	1/8 (3.2)	WL2018X7		1/8 (3.2)	WG018X7
	5/32 (4.0)	WL2532X7		5/32 (4.0)	—

## Replacement Parts

<b>Torch Body</b>		
W-400		WP-18SC
<b>Handle</b>		
Knurled		H-200
<b>Braided Rubber Power Cables and Hoses</b>		
	12.5 ft. (3.8 m)	25 ft. (7.6 m)
Power Cable	40V64R	41V29R
Water Hose	40V74R	41V32R
Gas Hose	40V75R18	41V30R18
<b>Vinyl Power Cables and Hoses</b>		
	12.5 ft. (3.8 m)	25 ft. (7.6 m)
Power Cable	40V64	41V29
Water Hose	40V74	41V32
Gas Hose	40V75	41V30

## Genuine Miller® Accessories



### Accessory Kit AK18C

Includes one short back cap, one of each size (#6, #7, #8) alumina nozzle, one of each size

(3/32, 1/8 HD, 5/32 HD) collet, one of each size (.020–1/8 inch, 1/8–3/16 inch) collet body, and one of each size (3/32, 1/8, 5/32 inch) 7-inch 2% ceriated tungsten electrode.

### Extension Kit

EK-1-25-R 25 ft. (7.6 m), rubber



### Cable Covers

WC-3-10

10 ft. (3 m)

WC-3-22

22 ft. (6.7 m)



### Wireless Remote Foot Control 300429

For remote current and contactor control. Receiver plugs directly into the

14-pin receptacle of Miller machine. 90-foot (27.4 m) operating range.



### Wireless Remote Hand Control 300430

For remote current and contactor control. Receiver plugs directly into the 14-pin receptacle of Miller machine.

300-foot (91.4 m) operating range.



### RCC-14 Remote Contactor and Current Control 151086

East/west rotary-motion fingertip control attaches to TIG torch using two hook-and-loop fasteners. Includes 26.5-foot (8 m) cord with 14-pin plug.



### RCCS-14 Remote Contactor and Current Control 043688

North/south rotary-motion fingertip control attaches to TIG torch using two hook-and-loop fasteners. Includes 26.5-foot (8 m) cord with 14-pin plug.



### Low-Conductivity TIG Coolant 043810

Sold in multiples of four in 1-gallon recyclable plastic bottles. Miller coolants contains a base of ethylene glycol and deionized water

to protect against freezing to -37° Fahrenheit (-38°C) or boiling to 227° Fahrenheit (108°C).

Distributed by:

**SUPERTECH SERVICES PVT. LTD.** Plot :- A253, Road 30B, Wagle Industrial Estate, Thane (West), Maharashtra, India. Tel :- +91 91360 97134 / +91 91360 97135 For more information visit us at : Email :- ssl@supertechservices.in www.supertechservices.in

